



Smart Revenue-Grade Flush Mount Meter

The NE Flush Mount Meter is perfect for applications where space is limited. Designed to sit flush against the wall, it is ideal for both new construction and retrofit projects, requiring minimal installation effort. The meter enclosure can be a standard off-the-shelf box (e.g., AMMO AR691, Orbit SDB-2, RACO 941) available for purchase by the customer directly or provided by Global Power Products upon request.

Utilizing cutting-edge technology, this meter automatically sends readings to the Cloud. It is available with a variety of communication options, including LTE Cat M1, Ethernet, Wi-Fi, and 900 MHz Radio Frequency, ensuring seamless data transmission.

Communication Options:

Powered by cutting-edge technology to automatically deliver meter readings to the cloud, NE Flush Mount Meters are available in a range of communication options:

- LTE Cat M1 (Connected by AT&T)
- Ethernet
- 900 MHz Radio Frequency
- BACnet-MSTP

Optional Features:

- DemRemote demand reset
- 2 pulse inputs (Dry or Wet)
- Time of Use
- On-board mass memory
- KYZ pulse output
- and Profiling

Accessing Your Data:

Access your electric meter's full history from anywhere by logging into the PowerTrack portal:

- Organize meters into groups
- Export data for monthly billing
- Create graphics illustrating usage in specific time ranges
- Perform remote demand resets

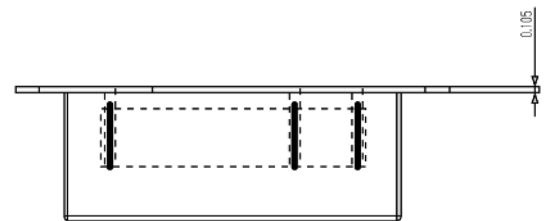
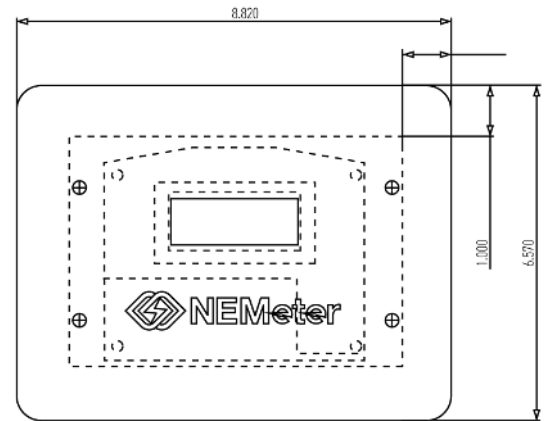

nemeter.com



Empowering Smarter Energy Management Solutions

info@globalpowerproducts.com • (800) 886-3837 • globalpowerproducts.com

© 2024 Global Power Products. All Rights Reserved.

Specifications

Operating Range:

Voltage: 96-528 Volts (absolute)
 Current: 100 - 5000 Amp Transformers Frequency: 47Hz to 63Hz
 Temperature: -400 C to +850 C
 Humidity: 0 to 95% non-condensing

Acceptable Services:

3 Phase 4 Wire Wye/Delta
 3 Phase 3 Wire Delta
 1 Phase 2 Wire or 3 Wire

Burdens:

Current Circuit:	Phase A, B, C	1VA max
Voltage Circuit:	Phase A	8.6VA max
Power Circuit:	Phase B & C	0.24 VA max.

Insulation, Surge Protection and Performance:

- Conforms to ANSI C12.20
- ANSI / IEEE C37.90.1 - 1989

Dimensions:

8.8 in. x 6.5 in.

MODELS	Energy Only (kWh)	Demand (kW)	Time of Use (TOU)	Active (kVA)	Reactive (kVAR)
NE-5000	✓				
NE-5100	✓	✓			
NE-5200	✓	✓	✓		
NE-5300	✓	✓	✓	✓	✓

Specifications

Current Transformer Details:

TYPE MX			
AMPERES PRI: SEC	NUMBER	INSIDE DIMENSIONS (INCHES)	OUTSIDE DIMENSIONS (INCHES)
100 : 0.1	512274-011	1.00 X 2.25	3.60 X 3.85
200 : 0.1	512274-012	1.00 X 2.24	3.77 X 3.73
400 : 0.1	512274-013	2.25 X 3.50	4.25 X 4.50
600 : 0.1	512274-014	2.25 X 3.50	4.25 X 4.50
800 : 0.1	512274-015	2.25 X 3.50	4.25 X 4.50
1000 : 0.1	512274-016	3.125 X 4.50	5.125 X 5.50
1200 : 0.1	512274-017	3.125 X 6.56	5.125 X 7.50
1600 : 0.1	512274-018	3.125 X 6.50	5.125 X 7.50
2000 : 0.1	512274-019	3.125 X 8.00	5.125 X 9.00
2500 : 0.1	512274-020	3.125 X 8.00	5.125 X 9.00
2500 : 0.1	512274-021	4.25 X 8.00	7.75 X 9.00
3000 : 0.1	512274-022	3.125 X 8.00	5.125 X 9.00
3000 : 0.1	512274-023	4.25 X 8.00	7.75 X 9.00

AWG Size	6	4	2	1	1/0	2/0	3/0	4/0	250	300	350	400	500	600	700	750	1000
DIA. (Inches)	.290	.335	.390	.460	.500	.540	.585	.635	.710	.760	.810	.850	.930	1.035	1.100	1.130	1.280

Dimensions:

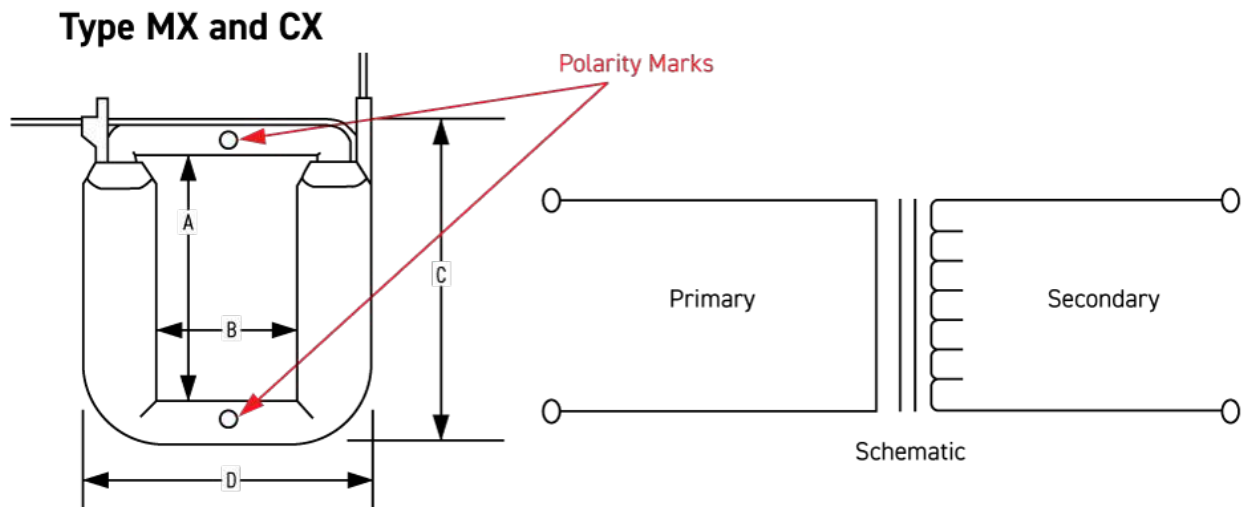

(Inside Dimension is A x B; Outside Dimension is D x C)

